

Diaphragm Type Globe Valves 2550 Series

Application

The 2550 series valves are designed for use in hospital and industrial piping systems where gases are supplied from a central source to branch outlets throughout the system.

Features

- UL listed for use with air, acetylene, hydrogen, LP-Gas, nitrogen, and oxygen service.
- Leakage is prevented by a dependable diaphragm stem seal.
- A resilient seat disc provides positive shut-off.
- Heavy duty ACME stem threads assure easy operation and long working life.
- Maximum working pressure is 250 PSIG.
- Working temperature range is -40°F to +165°F.
- 100% Factory Tested



2554AC

Materials

Body (2553 series)	Forged Brass
Body (2554 series)	Cast Bronze, Tin Plated
Handwheel	Aluminum
Seat Disc	Filled Teflon
Diaphragm	Neoprene
Bonnet	Brass
Stem	Manganese Bronze

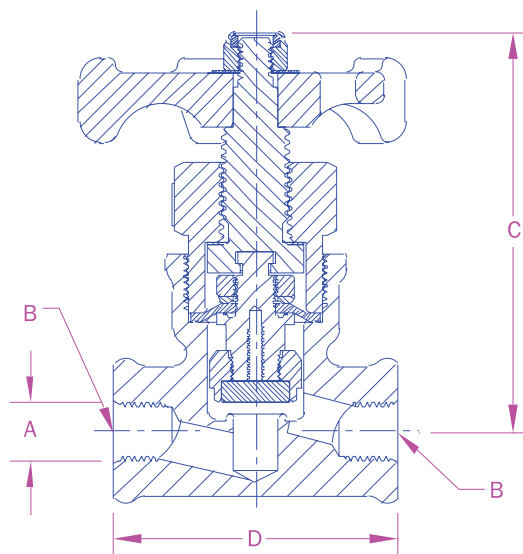

Ordering Information

Part Number	Inlet/Outlet Thread (Female NPT) A	Port Diameter B	Height C	Length D	Cv Factor
2553AC	1/4"	13/32"	3 3/8"	2 1/2"	1.4
2553AAC	3/8"				1.5
2554AC	1/2"	11/16"		3 1/8"	4.3
2554AAC	3/4"				4.3